

REV.	ECN.NO.	MODIFY.CONTENT
------	---------	----------------

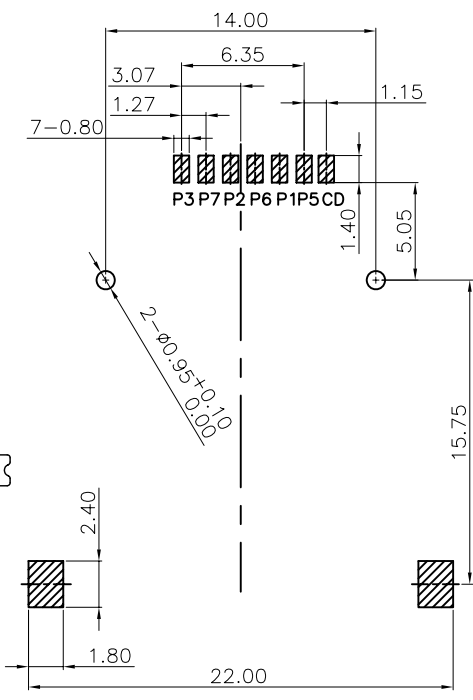
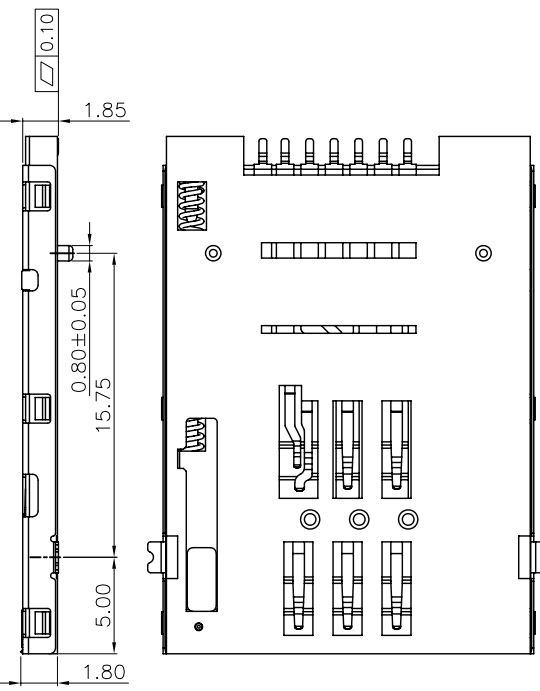
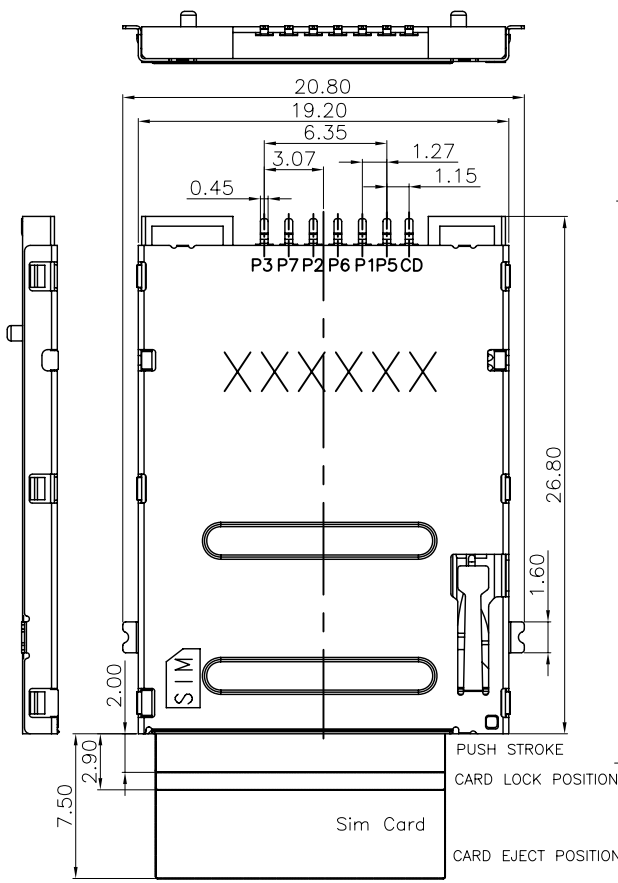

CARD DETECTION SWITCH:

WHEN CARD IS WITHDRAWAL	WHEN CARD IS INSERTED
OPEN	SHORT

CONNECTOR TERMINAL NO.	PIN NO.
PIN 1	VCC : PWR SIGNAL AND GND
PIN 2	RST : RESET SIGNAL
PIN 3	CLK : CLOCKING SIGNAL
PIN 5	GND : PWR SIGNAL AND GND
PIN 6	VPP : PROGRAMMING VOLTAGE
PIN 7	I/O :SERIAL DATA INPUT/OUTPUT

- NOTES :
- MATERIAL :
 - HOUSING:LCP UL94 V-0, BLACK COLOR.
 - SHELL: STAINLESS STEEL
 - CONTACT: COPPER ALLOY
 - FINISH :
 - CONTACT: GOLD PLATING ON CONTACT AREA, MATTE TIN 100u"MIN ON SOLDERTAIL AREA. 50u" MIN NICKEL PLATING OVERALL.
 - SHELL: 30u" MIN NICKEL PLATING OVERALL. Au 1u"MIN ON SOLDERTAIL AREA.
 - ELECTRICAL CHARACTERISTICS:
 - OPERATING VOLTAGE : 100V AC(rms)/DC.
 - CURRENT RATING : 0.5 A.
 - OPERATING TEMPERATURE: -25°C~+85°C.
 - CONTACT RESISTANCE: 100 m OHMS MAX.
 - INSULATION RESISTANCE: 1000M OHMS MIN. AT 250VDC.
 - DIELECTRIC WITHSTANDING VOLTAGE:500 VAC/1MINUTE.

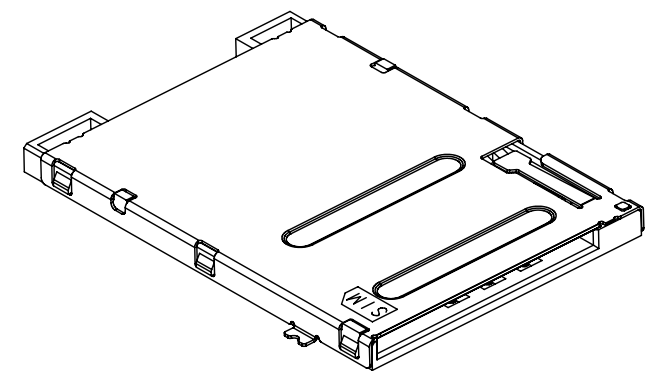

PART.NO.:
SP120-AP401-**

- 42: 功能区镀金1U", 锡脚镀雾纯锡至少100U"
- 43: 功能区镀金3U", 锡脚镀雾纯锡至少100U"
- 44: 功能区镀金5U", 锡脚镀雾纯锡至少100U"
- 45: 功能区镀金10U", 锡脚镀雾纯锡至少100U"
- 46: 功能区镀金15U", 锡脚镀雾纯锡至少100U"
- 47: 功能区镀金30U", 锡脚镀雾纯锡至少100U"

GENERAL TOLERANCE	DWG.NO.	SP120-AP401-00	PART.NO.	SP120-AP401-**	DRAWN	L.M.J 2018.09.29	UNIT	mm	SCALE	1:1
x.±0.50	REV.	A	TITLE	SIM Push H1.85(6+1P)conn.	CHECKED		东莞市欧联电子科技有限公司 DONGGUAN OLN ELECTRONICS TECHNOLOGY CO., LTD.			
.x±0.30	SIZE	A4	SHEET	1 OF 2	APPROVED					
.xx±0.20	A4									

东莞市欧联电子科技有限公司

包装作业规范

REV.	ECN.NO.	MODIFY.CONTENT
------	---------	----------------

包装作业图示及说明 (PACKING OPERATION DIAGRAM & INSTRUCTION)

- 一.
- 1) 将成品一一放入REEL包装盘内,依同一方向放入.
 - 2) 包装时,如图所示.
 - 3) 一个REEL包装盘放置600个成品.

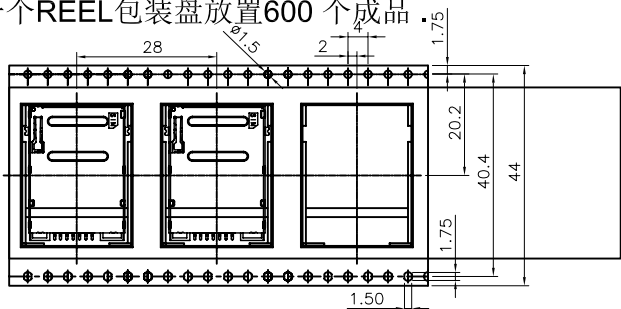

- 三.
- 1) 每箱装 6 盘REEL包装盘.
 - 2) 每箱放置 3600 PCS 的成品.

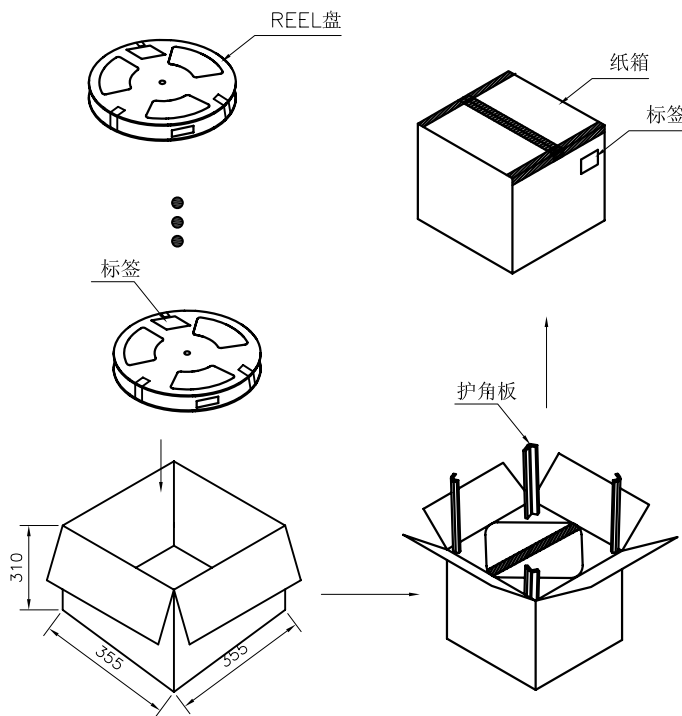

- 四.
- 1) 用TAPE将纸箱封实.

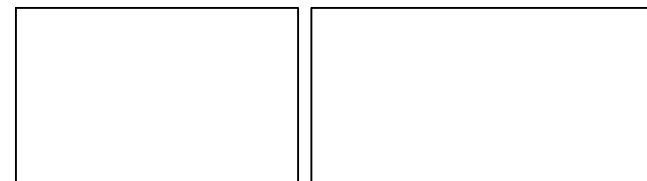

- 二.
- 1) 装盘前先把前面空15pcs产品,然后再开始装盘, 尾端也需空15pcs产品,上带加长200mm.
 - 2) 装满成品的REEL包装盘如下图所示.

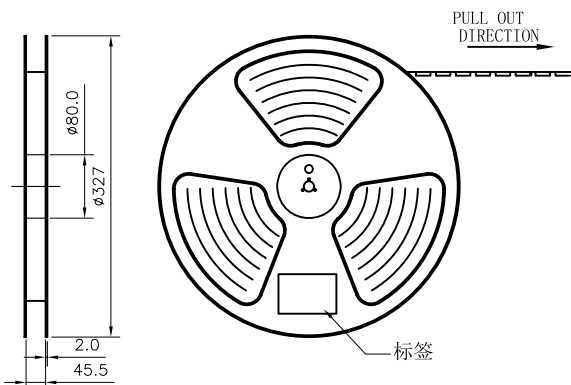

备注 (REMARK)

1. 若有未装满之零数箱,必须以缓冲材塞满.

N.W: 3.99 KGS

G.W: 8.31 KGS

GENERAL TOLERANCE	DWG.NO.	SP120-AP401-00	PART.NO.	SP120-AP401-**	DRAWN	L.M.J 2018.09.29
x.±0.50	REV.	A	TITLE	SIM Push H1.85(6+1P)conn.	CHECKED	
.x±0.30	SIZE		SHEET	2 OF 2	APPROVED	
.xx±0.20	A4					

UNIT	mm	SCALE	1:1
东莞市欧联电子科技有限公司 DONGGUAN OLN ELECTRONICS TECHNOLOGY CO., LTD.			